

COLT'S

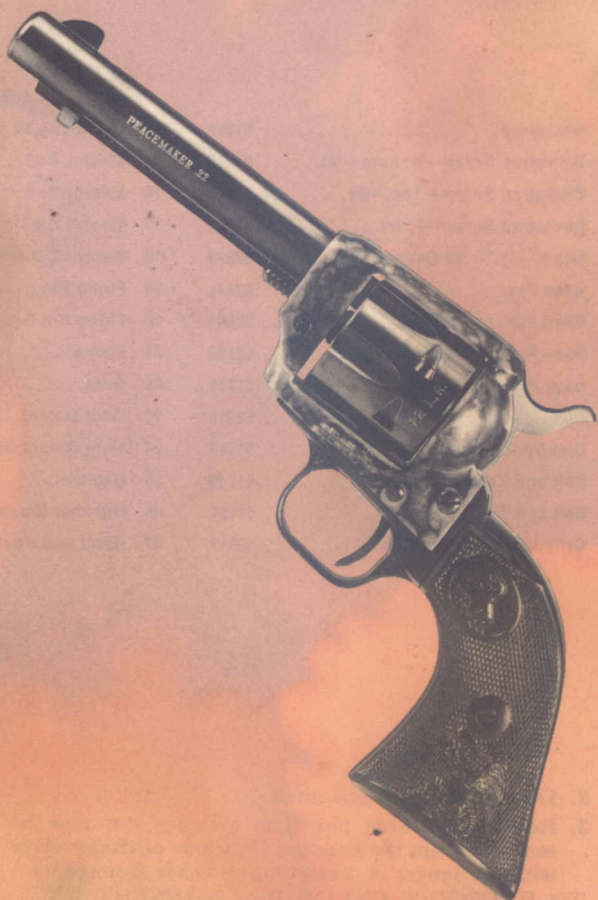

Peacemaker .22 Caliber

REVOLVER

Loading • Firing • Correct Care

COLT'S

Peacemaker .22 Caliber Single Action Revolver



LOADING

FIRING

CORRECT CARE

GENERAL. Your Colt Single Action Peacemaker is one of the most simple, rugged and dependable handguns ever manufactured. Used correctly it will serve you indefinitely without ever requiring major repairs. Before handling or shooting your Single Action, BE SURE to read this sheet and carefully note the precautions listed. These precautions, though important, are simple, and correct handling will quickly become automatic with you. The precautions apply to EVERY single action revolver and are dictated by the inherent mechanical structure of ALL handguns of this type.

ACTION. "Single Action" means that the hammer of this revolver must be drawn back—or "cocked"—with the thumb, before each shot is fired. When cocking the Single Action, you will notice that there are *three* distinct hammer positions as follows:

1. **SAFETY POSITION**—with the hammer held safely away from the firing pin.
2. **HALF-COCK**—with the hammer approximately half way back and the cylinder bolt depressed, leaving the cylinder free to rotate.

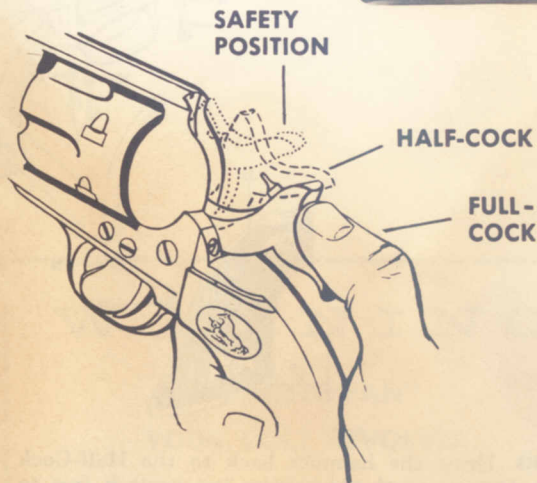

3. **FULL-COCK**—with the hammer all the way back and the revolver ready to fire.

IMPORTANT—The Safety and Half-Cock notches are designed to *prevent* the trigger from being pulled, so Do NOT try to force the trigger with the hammer in either of these two positions. If it is desired to lower the hammer, pull the hammer back slightly; then pull the trigger and lower the hammer *carefully*.

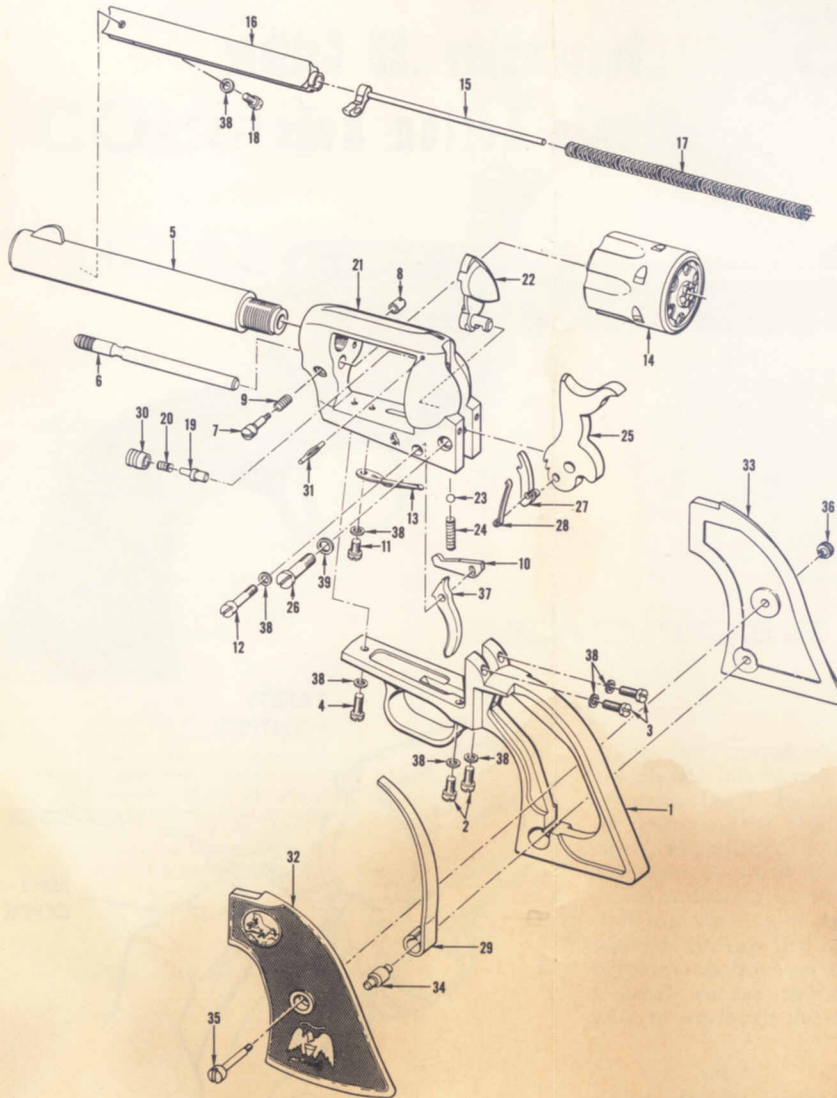

LOADING. Draw the hammer back to the Half-Cock position. Do not touch the trigger but leave it free to snap into the notch. (NOTE: If the hammer should be at the Full-Cock position, lower it *all the way first* and then draw back to Half-Cock. Otherwise, the bolt cam lever cannot operate to release the cylinder.) This will leave the cylinder free to rotate for loading. Open the Loading Gate on the right-hand side of the revolver and load each chamber. Close the loading gate.

UNLOADING. After firing, draw the hammer back to Half-Cock position, open the gate and operate the ejector lever (located under the barrel) to eject the empty cartridge cases.

SAFE POSITION—CARRYING. The safest way to carry your Colt Single Action Peacemaker is with five

cartridges in the chamber and the hammer on the empty sixth chamber.

IMPORTANT—When placing the hammer in the Safety position, first lower it all the way *gently* (since dropping the hammer hard can fire the cartridge) and then draw it back to the Safety position. If the hammer is incorrectly lowered, direct from the Half- or Full-Cock positions to the Safety position, the sear may not engage the hammer notch completely and safely.

REMOVING THE CYLINDER. To remove the cylinder for cleaning, inspection or exchange (dual cylinder model):

1. BE SURE the hammer is in the Half-Cock position with the cylinder free to rotate (see Note under paragraph on Loading). Make sure the Loading Gate is open.

