

*J. C. Higgins*

**MODEL 60**

**AUTOMATIC  
SHOTGUN  
12 Gauge**

**The J. C. Higgins Model 60 is the world's fastest-firing shotgun — and the first and only automatic shotgun with a stationary barrel and chamber.**

**POWER-PISTON** Automatic Action employs a gas-operation principle similar to World War II's famous M-1 rifle. Does all the work of loading, cocking and extracting for you. You just pull the trigger for each shot; the action does the rest. Immediately after the shot charge has left the barrel, POWER-PISTON Automatic Action completely harnesses the residual gases of the fired shell.

**FIVE SHOTS IN ONE SECOND** — fire five shots just as quickly as you can pull the trigger. It takes only one second — the fastest-shooting shotgun in the world. You'll get your game with the Model 60.

**LESS RECOIL** — far less barrel-whip and muzzle-blast than any other uncompensated gun — proved in actual laboratory tests. Far less recoil allows perfect pointing on second and third shots! The light weight piston operated by residual gases speeds the bolt into action *quickly, smoothly, positively*, and there is **ABSOLUTELY NO REDUCTION IN POWER BEHIND THE SHOT CHARGE.**

You'll marvel at the light recoil of the deluxe model. Residual gas pressures mean fast automatic action without barrel slamming recoil. The Model 60 is a powerful 12-gauge gun with the feel and handling of a 20!

**AMERICA'S MOST VERSATILE SHOTGUN** — choose from three models to meet *your* exact shooting needs:

1. Lightweight Model 60 with plain barrel — weighs less than 7½ lbs., points naturally, balances perfectly.
2. Lightweight Model 60 with Ventilated Rib — gives you a perfect sighting plane — the only automatic on the market with a

factory-installed ventilated rib. And its full-length rib aligns perfectly with the receiver.

3. Deluxe Model 60 with Ventilated Rib and Chokemaster choke control and compensator — the finest game-getter you can buy, yet it costs only a little more than the plain- or rib-barrel models. The CHOKEMASTER gives you seven positions of choke in a twist of the wrist, from extra full to skeet choke. It works like the nozzle on your garden hose; it's quick and easy and gives split-second changes in choke patterns in the field. No tubes to change! The CHOKE-MASTER makes your Model 60 America's most versatile shotgun. You can shoot anything from deer to quail — plus trap and skeet as well. Count on this gun to give you the kind of speed and performance that's bound to increase your bag of game and give you better scores in competitive skeet and trap shooting, too. With the CHOKE-MASTER in "Cylinder" position the Model 60 becomes the most accurate shotgun on the market for shooting rifled slugs.

**SHOOTS ALL FOUR LOADS** — automatically, interchangeably without adjustment. Handles the lightest trap and skeet loads — heavy field loads or slugs, and even the new 2¾ in. magnum loads. Gives you dependable automatic action every time.

**SIMPLICITY IN DESIGN** — Power Piston Automatic Action makes it possible for you to buy a Model 60 at an unbelievably low price. Prove this to yourself by comparing the J. C. Higgins price and performance with any other automatic shotgun made.

**LIGHTWEIGHT** — you don't have to pay extra for this feature on the J. C. Higgins Model 60. The plain-barrel model weighs less than 7½ lbs. The balance on all three models is perfect with weight equalized throughout, not concentrated in butt or fore-end.

**PERMANENTLY INTERLOCKED BARREL AND RECEIVER** — this gun can't shoot loose. It gives you a full, undistorted, positively aligned sighting plane for fast pointing and more game. The

J. C. Higgins Model 60 also has a silver nameplate for your initials, a personalized extra feature.

*Keep your Model 60 CLEAN*, and it will give you a lifetime of dependable service.

**TO CLEAN THE MODEL 60** — dirt and fouling should be periodically removed from the bolt, extractors, and other operating parts. This should be done with a tooth brush soaked in Nitro solvent (included in J. C. Higgins Cleaning Kits). Following this, all moving parts should be wiped dry and oiled lightly.

Exclusive use of J. C. Higgins ammunition practically eliminates any need for barrel cleaning. Should powder residue or any dirt accumulate in the barrel, however, it can easily be removed.

Open the action, rest the heel of the stock on the floor and hold the gun barrel near the muzzle with the left hand. Push a brass cleaning brush soaked in Nitro solvent through the muzzle end, and work it up and down throughout the entire length of the bore. Follow this by wiping the bore with clean patches until the last one comes out unsoiled. A light protective film of oil may be applied with a patch if desired.

A J. C. Higgins Shotgun Cleaning Kit (available at any Sears Store or from the catalog) includes all of the necessary items for easy cleaning of your shotgun. Another piece of valuable equipment is a J. C. Higgins Silicone Cloth which will completely protect outside surfaces of the gun from any rust due to finger prints or moisture by rubbing "once-over-lightly."

**ONLY J. C. HIGGINS GUNS ARE SILICONIZED AND POLARIZED** — new siliconized and polarized oil protects your Model 60. This exclusive, patented process gets down into the pores of the steel and protects against perspiration and other corrosive elements which cause rust. This makes J. C. Higgins guns the most rust-resistant of any guns you can buy. It gives the best lubrication of any oil tested. And it protects and beautifies stock and forearm.

# OPERATING INSTRUCTIONS

**TO MAKE GUN SAFE:** Safety is located in trigger-guard bow forward of trigger. Push safety button from left to right until red band is covered. This locks trigger and gun cannot be fired. Always lock the trigger when carrying a loaded gun.

**TO RELEASE SAFETY:** Push safety button from right to left, exposing red band, and gun is ready to fire.

**TO LOAD CHAMBER:** Open action fully by pulling operating handle all the way to rear. Drop shell in loading port. Push cartridge stop button (see Figure 1) and action will close, carrying shell into chamber. Push safety button from left to right.

**TO LOAD MAGAZINE:** Hold in cartridge stop button and insert shells upward into bottom of receiver as in Figure 1 and push forward into magazine tube past cartridge stops. Repeat until magazine is full. Magazine will hold 4 shells, or 2 when plugged to conform with certain game laws (see "PLUGGING MAGAZINE FOR 3 SHOTS" on page 8). Chamber holds one additional shell.

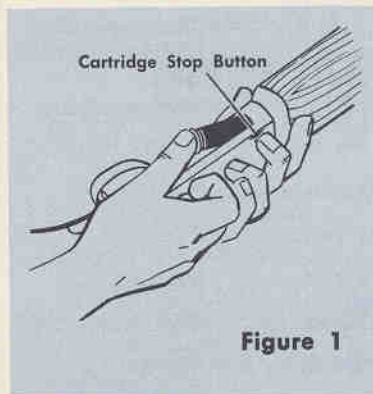

## CHOKEMASTER ADJUSTMENTS:

Turn the knurled sleeve clockwise as far as it will go. Then back off very slightly until the sleeve clicks and the words "XTRA FULL" line up with the front sight. This shows that the CHOKEMASTER is adjusted to throw the tightest choke pattern.

To decrease the degree of choke, unscrew the sleeve counterclockwise a click at a time. The markings that appear opposite the reference mark at each click tell you

the degree of choke, from extra-full choke to cylinder. To obtain skeet choke, rotate the sleeve counterclockwise one click beyond "Cylinder" position to "Xtra-Full" reference mark. Do not unscrew the sleeve beyond this position when shooting.

Figure 2



## SPECIFICATIONS

	<i>Lightweight</i>	<i>Lightweight with rib</i>	<i>Deluxe</i>
Gauge	12 ga.	12 ga.	12 ga.
Choke	Full, Modified Improved Cylinder	Full	Seven-position "Chokemaster" and compensator
Weight	7½ lbs.	7¾ lbs.	8 lbs.
Length of pull	14 in.	14 in.	14 in.
Drop at Comb	1½ in.	1½ in.	1½ in.
Drop at heel	2½ in.	2½ in.	2½ in.
Barrel length	28 in.	28 in.	26¼ in.
Pitch	2⅞ in.	2⅞ in.	2⅞ in.
Sight	Bead front sight	Bead front sight	Bead front sight
Length	47⅞ in.	47⅞ in.	46¼ in.

Figure 2



## J. C. HIGGINS MODEL 60 GAS-OPERATED SHOTGUN

### How Power-Piston Automatic Action Works

Figure 3

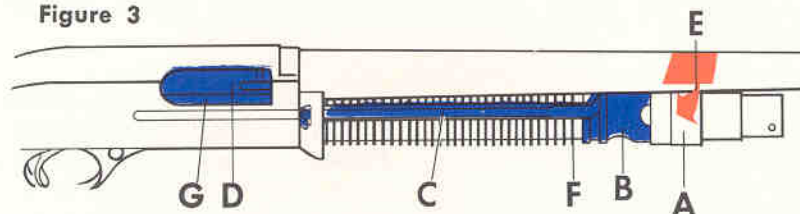
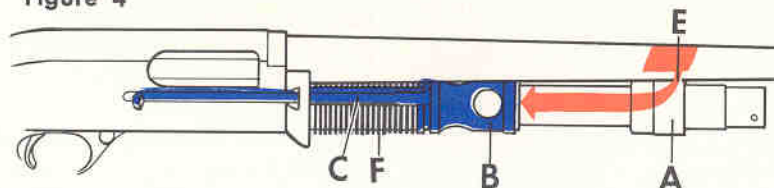

Figure 4



When the gun is fired and the shot charge passes the gas ports in the barrel, a small, scientifically measured part of the gas passes through the ports (E) into cylinder (A) (see Figure 3). This gas pushes against the piston (B), compressing action spring (F) and driving the piston, together with action bar (C) and slide (G), a short distance to the rear *before bolt (D) starts to unlock*.

This slight delay allows the shot charge to be well out of the muzzle and residual gas pressure in the barrel to drop before bolt is unlocked and carried rearward (see Figure 4).

This motion extracts and ejects the fired shell and releases the next round from the magazine.

Action spring (F) immediately forces the action bar and piston to return to the closed position, loading the next shell and closing and locking the bolt upon it, ready for firing.

The action always remains open after the last shot has been fired.

The bolt can be closed again by pressing cartridge stop button located on the left side of the receiver.

## SPECIFICATIONS

	Lightweight	Lightweight with rib	Deluxe
Gauge	12 ga.	12 ga.	12 ga.
Choke	Full, Modified Improved Cylinder	Full	Seven-position "Chokemaster" and compensator
Weight	7½ lbs.	7¾ lbs.	8 lbs.
Length of pull	14 in.	14 in.	14 in.
Drop at Comb	1½ in.	1½ in.	1½ in.
Drop at heel	2½ in.	2½ in.	2½ in.
Barrel length	28 in.	28 in.	26¼ in.
Pitch	2½ in.	2½ in.	2½ in.
Sight	Bead front sight	Bead front sight	Bead front sight
Length	47⅞ in.	47⅞ in.	46¼ in.



## J. C. HIGGINS MODEL 60 GAS-OPERATED SHOTGUN

### How Power-Piston Automatic Action Works

Figure 3

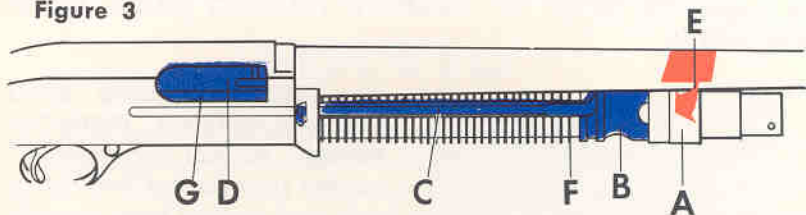
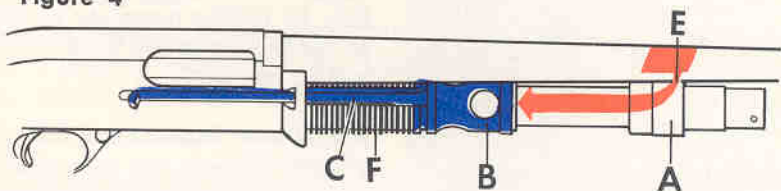

Figure 4



When the gun is fired and the shot charge passes the gas ports in the barrel, a small, scientifically measured part of the gas passes through the ports (E) into cylinder (A) (see Figure 3). This gas pushes against the piston (B), compressing action spring (F) and driving the piston, together with action bar (C) and slide (G), a short distance to the rear *before bolt (D) starts to unlock*.

This slight delay allows the shot charge to be well out of the muzzle and residual gas pressure in the barrel to drop before bolt is unlocked and carried rearward (see Figure 4).

This motion extracts and ejects the fired shell and releases the next round from the magazine.

Action spring (F) immediately forces the action bar and piston to return to the closed position, loading the next shell and closing and locking the bolt upon it, ready for firing.

The action always remains open after the last shot has been fired.

The bolt can be closed again by pressing cartridge stop button located on the left side of the receiver.



**TO OPERATE:** The gun will fire once each time the trigger is pulled, until the last shell is fired. Then the action remains open, indicating that the gun is empty and making it easier to load the chamber.

**TO REMOVE LOADED SHELLS FROM MAGAZINE:** Push safety button from left to right, locking the trigger. BE SURE RED BAND ON SAFETY BUTTON IS NOT VISIBLE. Turn gun over with trigger guard up. Push cartridge stop button and depress cartridge lifter (see Figure 5). Holding cartridge lifter down, press in cartridge stop on inside of receiver (the left side, with gun upside down) to release shell from magazine. Repeat procedure until magazine is empty. BE SURE TO REMOVE LOADED SHELL FROM CHAMBER.

Figure 5

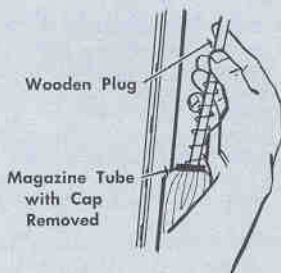
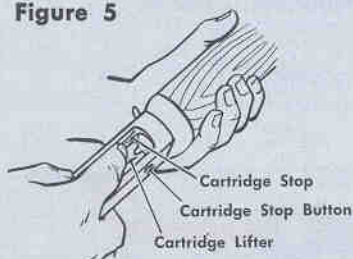

Figure 6

**TO REMOVE LOADED SHELL FROM CHAMBER WITHOUT FIRING:**

Be sure that safety button has been pushed from left to right, and that red band on safety button is not visible. Open action fully by pulling operating handle all the way back and loaded shell will be extracted.

**PLUGGING MAGAZINE FOR 3**

**SHOTS:** Using a coin as a screwdriver, loosen screw on fore-end cap and take off cap . . . screw will remain in cap. Then unscrew magazine tube cap carefully, allowing spring to emerge slowly. Put wooden plug in the center of magazine spring (see Figure 6) and reassemble. This reduces magazine capacity to only 2 shells which, with one shell in the chamber, reduces the gun's total capacity to 3 shells, as required by the game laws of certain states.

## DISASSEMBLY

**TO REMOVE TRIGGER GUARD ASSEMBLY:** With pencil point or small screwdriver, push out trigger guard retaining pins (see Figure 2) from right or left side of receiver. Trigger guard assembly will then lift out easily as a unit.

**SLIDE AND BOLT ASSEMBLY:** Turn over gun. Then pull operating handle back all the way with right hand, holding left hand under receiver, and slide and bolt assembly will fall into left hand. Take care not to permit pin that retains firing pin and ejector to fall out.

## ASSEMBLY

**SLIDE AND BOLT ASSEMBLY:** Put bolt assembly and slide together by mating angle on the bottom of bolt assembly with cut in slide (see Figure 7). Drop bolt and slide together into rear of receiver. Pull operating handle back and lift up slide so that lug on action bar slips into notch on slide.

**TRIGGER GUARD ASSEMBLY:** Make certain that hammer is in a cocked position (see Figure 8). Then insert trigger guard assembly and replace trigger guard retaining pins from left or right.

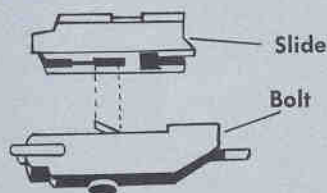

Figure 7

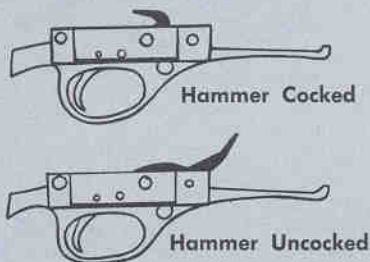

Figure 8

# LIST OF PARTS AND ASSEMBLIES

J. C. HIGGINS MODEL 60, 12 Gauge, Model 583.62, 583.63 or 583.64. (One of these numbers is marked on the barrel. Be sure to mention it when ordering.)

HOW TO ORDER: Specify Model No. 583.62, 583.63 or 583.64, as well as Reference Num-

ber, Part Number and Part Name. Parts marked with an asterisk (\*) must be fitted by gunsmiths in Sears gun shops or by other competent gunsmiths.

WHERE TO ORDER: Any Sears retail or mail-order store will be glad to handle your order.

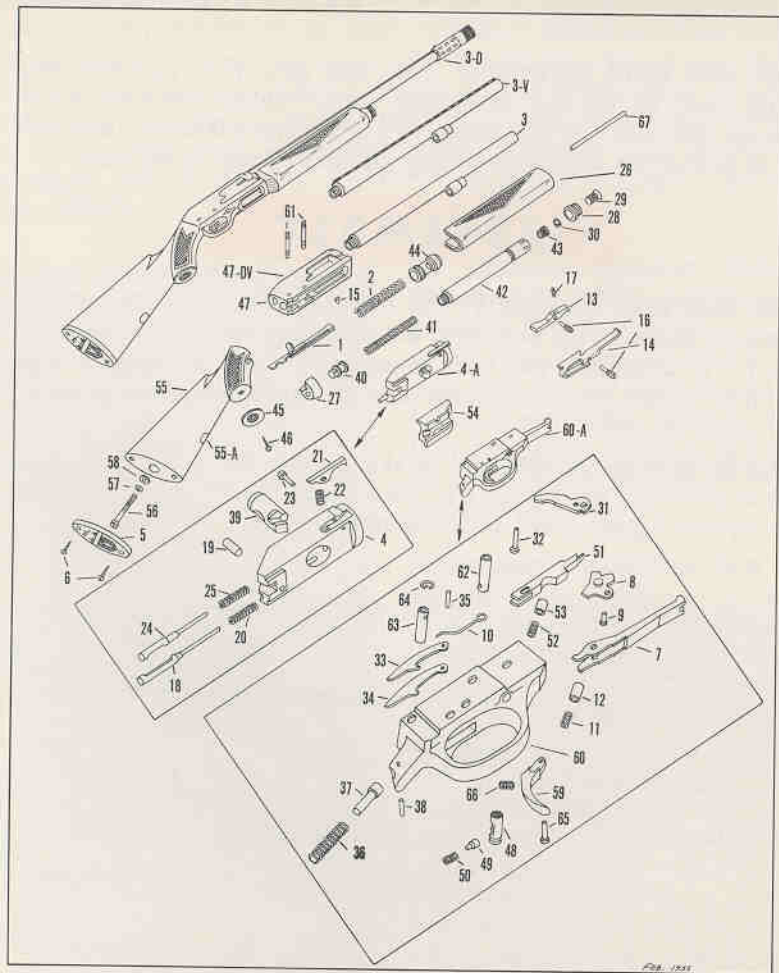

REF. NO.	PART NO.	PART NAME	REF. NO.	PART NO.	PART NAME
1	640	Action Bar Assembly	33	641	Hammer Strut, R. H.
2	618	Action Spring	34	642	Hammer Strut, L. H.
*3	602	Barrel, Plain	35	643	Hammer Strut Pin
*3-V	624	Barrel with Ventilated Rib	36	133	Hammer Spring
*3-D	661	Barrel Deluxe, with Choke-master	37	639	Hammer Spring Guide
4	603	Bolt	38	676	Hammer Spring Retaining Pin
4-A	698	Bolt Assembly	55-A	178	Initial Plate
5	620	Butt Plate	39	691	Locking Pin
6	345	Butt Plate Screw	40	645	Magazine Follower
7	608	Cartridge Lifter	41	646	Magazine Spring
8	677	Cartridge Lifter Actuator Assembly	42	647	Magazine Tube
9	610	Cartridge Lifter Actuator Hinge Pin	43	648	Magazine Tube Cap
10	675	Cartridge Lifter Actuator Spring	44	651	Piston
11	650	Cartridge Lifter Spring	45	188B	Pistol Grip Cap
12	689	Cartridge Lifter Spring Plunger	46	403	Pistol Grip Cap Screw
13	612	Cartridge Stop, R. H.	*47	606	Receiver (for plain-barrel)
14	613	Cartridge Stop, L. H.	*47-DV	692	Receiver (for deluxe and ventilated-rib barrel)
15	679	Cartridge Stop Button	48	659	Safety Button
16	616	Cartridge Stop Pin	49	605	Safety Spring Plunger
17	656	Cartridge Stop Spring	50	155B	Safety Plunger Spring
18	621	Ejector	*51	662	Sear
19	627	Ejector and Firing Pin Retaining Pin	52	649	Sear Spring
20	628	Ejector Retracting Spring	53	652	Sear Spring Plunger
21	622	Extractor, R. H.	54	664	Slide
22	625	Extractor Spring, R. H.	55	665	Stock
23	604	Extractor Pivot Pin	56	666	Stock Bolt
24	626	Firing Pin	57	667	Stock Bolt Lock Washer
25	628	Firing Pin Retracting Spring	58	668	Stock Bolt Washer
26	658	Forehand Assembly	59	669	Trigger
27	630	Forehand Base	60	670	Trigger Guard
28	631	Forehand Cap	60-A	680	Trigger Guard Assembly
29	632	Forehand Cap Screw	61	671	Trigger Guard Retaining Pin
30	633	Forehand Cap Screw Retaining Ring	62	672	Trigger Guard Retaining Pin Bushing, Front
31	636	Hammer	63	673	Trigger Guard Retaining Pin Bushing, Rear
32	699	Hammer Hinge Pin	64	674	Trigger Guard Retaining Pin Bushing Retaining Spring
			65	699	Trigger Hinge Pin
			66	657	Trigger Spring
			67	685	Wood Plug
				991-35	Parts List

# OTHER FAMOUS *J. Higgins* GUNS

See these other J. C. Higgins models at your nearest Sears Store, or send a postcard for descriptive literature on all J. C. Higgins Guns to: Sears, Roebuck and Company, Dept. 139, Chicago, Illinois. Ask for J. C. Higgins Circular No. 6495. Remember, these guns give you more quality and shooting pleasure for every dollar you invest!

## Model 88 .22 REVOLVER



A fine 9-shot revolver at an amazingly low price. This double- and single-action revolver of truly modern design is perfectly balanced and packed with the features and precision workmanship of handguns costing twice as much. Choice of 4" or 6" barrel. Uses .22 shorts, longs and long rifles, hi-speed or regular. Swing-out counterbored cylinder, crisp trigger pull, single-stroke multiple ejection, adjustable rear sight, comfortable thumb-rest grips. Weight 23 oz. with 4" barrel, 25 oz. with 6" barrel.

## Model 33 PUMP-ACTION .22



Printed in U.S.A.  
Parts List 991-35

The Model 33 is the slickest .22-caliber pump-action rifle ever made! It's accurate, rugged and dependable, in the field and on the range. Uses regular or high-speed ammunition in .22-caliber rimfire interchangeably and without adjustment. Magazine holds 17 Long Rifle, 20 Long, or 25 Short cartridges. Features beautiful American Walnut butt stock and forearm, built-in base for telescopic sight, quick, crisp, easy action, and ramp-style front sight. A 4-power telescopic sight specifically adapted to this gun is available at low cost.

## Model 31 .22 RIFLE



5-55

The versatile Model 31 is tops for field shooting and target practice. It operates with regular or high speed ammunition in .22 cal. rimfire which can be used interchangeably, without adjustment, in the magazine which holds 17 Long Rifle, 19 Long, or 25 Short shells. Outstanding with this rifle are a built-in mount base, a roll-away Nylon carrying sling, and a ramp-style front sight. A 4 power telescopic sight is available which is specifically adapted to Model 31.

J. C. Higgins Guns are sold **ONLY** by Sears, Roebuck and Co.  
and Simpsons-Sears Limited