

**MODEL TEN**  
**SERIES "A"**  
**12 GAUGE AUTOLOADING POLICE SHOTGUN**  
CATALOG #8290



**OPERATING INSTRUCTIONS AND PARTS LIST**

**HOW TO ORDER REPAIR PARTS**

The following information must be furnished when ordering replacement parts:

1. Model Name and Number
2. Catalog Number
3. Number and Name of Parts

**SHOTGUN SHIPPING INSTRUCTIONS**

**CAUTION:** For safety of all concerned — Be absolutely certain shotgun is empty . . . with no shells in chamber and magazine.

Shotgun should be securely packaged in a throwaway carton to prevent damage in transit. Do not ship shotgun to the factory in gun carrying case or other special containers which must be returned by our service department.

Shotgun should be shipped to the factory — Express Prepaid or insured parcel post.

REMEMBER: All Shipments to the factory must be Prepaid.

**FACTORY SERVICE**

If parts are to be fitted at the factory, send firearms marked for the attention of our SERVICE DEPARTMENT, furnishing complete and specific repair instructions. A cost estimate of the parts and labor charges will be immediately sent for your approval before work is started. Unless a flat rate charge is specified, a MINIMUM of \$6.50 will be charged on servicing firearms at the factory.

**MINIMUM ORDER \$1.00**

A minimum charge of \$1.00 is made on all orders where the normal cost would be less than \$1.00. If you wish, order extra parts to make up the minimum charge.

**PAYMENT**

All parts shipments will be made by Parcel Post C.O.D. unless advance remittance is made.

PLEASE DO NOT SEND CASH OR STAMPS. Checks, Money Orders, or Drafts are acceptable and will save you C.O.D. charges.

## OPERATING INSTRUCTIONS

The Model Ten Police Shotgun is gas operated, using a part of the gas pressure generated to operate the action of the firearm. This results in a reduction of the recoil of about 50% (compared to a pump-action shotgun). The Model Ten is designed to function either 2¾" high base or 2¾" magnum loads, interchangeably, without adjustment.

### CLEANING EXTERIOR

For trouble free operation, clean the heavy protective oils from the exterior before firing. After cleaning, coat the **exterior** with light gun-oil. (Cleaning of the "action" is explained in a later part of the instructions). The Model Ten is shipped without batteries. You will need 2 standard "D" Cells or a suitable rechargeable unit. A rubber "O" ring is supplied with each gun to be used on the top battery or on the top portion of the rechargeable unit. (See illustration #1).

Since the primary use for police shotguns is of an intermittent nature, it is suggested that a periodic check of the gun be made to insure that the action is functioning properly. The best method is to function five or ten rounds through it. This will provide additional experience in loading and handling of the Model Ten.

ILLUSTRATION #1

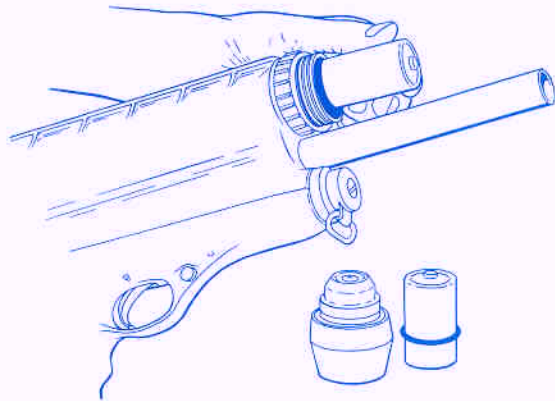

**INSTALLING BATTERIES** — Unscrew search-light head and insert rear battery. Slip "O" ring on forward battery approximately one-third from the base. Insert battery and replace search-light head. When using a rechargeable unit position the "O" ring as indicated above.

**Note:** If switch ring is removed be sure to line up notch with contact bar before re-assembling search-light head.

ILLUSTRATION #2

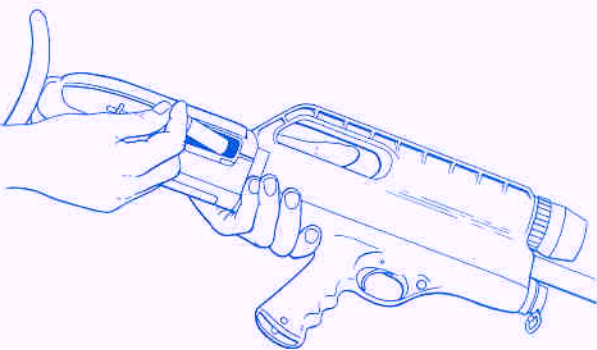

**TO LOAD FIRST SHELL INTO CHAMBER** — Engage safety by pushing from left to right. Open the action by pulling action handle all the way to the rear. (Action will lock into "Open" position.) Drop shell into loading port. Push cartridge stop button and action will close, carrying shell into chamber.

ILLUSTRATION #3

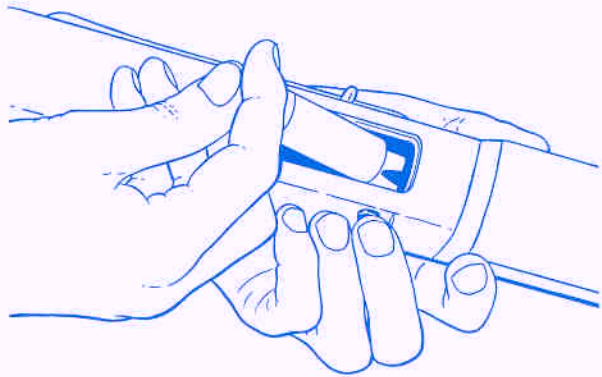

**TO LOAD MAGAZINE** — Depress and **hold** cartridge stop button. Insert shells into magazine tube, being sure to push each shell past the cartridge stops. The best method for doing this is to hold the gun with the top of the receiver in the palm of the left hand with the cartridge stop button depressed. Load four shells into the magazine tube by pushing downward and forward. Magazine holds four 2¾" shells.

The gun is now fully loaded and ready to fire. To dis-engage the safety push from right to left (the red ring on the safety will now appear).

**Note:** When firing the gun be sure it is positioned so that the ejection port is facing outward to the right.

**TO UNLOAD MAGAZINE** — Push safety button from left to right, locking trigger. **Be sure Red Band on Safety is not visible.** Turn gun over — push cartridge stop button and depress cartridge lifter. Holding cartridge lifter down, press in cartridge stop on inside of receiver (the left side with gun upside down) to release shell from magazine. Repeat procedure until magazine is empty. **Be sure to Remove Loaded Shell from Chamber.**

**TO REMOVE LOADED SHELL FROM CHAMBER** — Be sure that safety button has been pushed from left to right and that red band on safety is not showing. Open action fully by pulling operating handle all the way back and loaded shell will be extracted.

## EXPLODED VIEW OF MODEL TEN

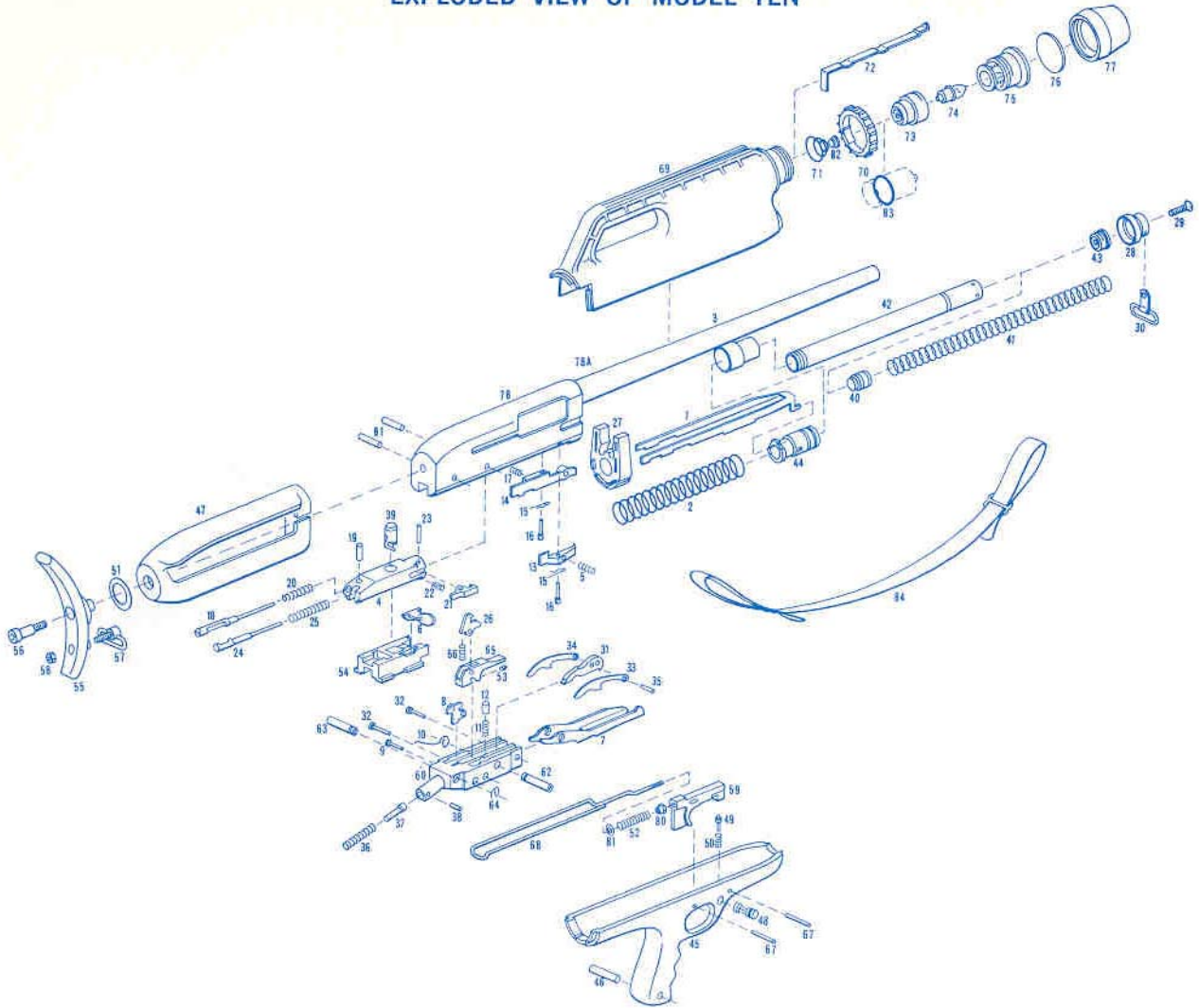

## EXPLODED VIEW OF MAJOR COMPONENTS

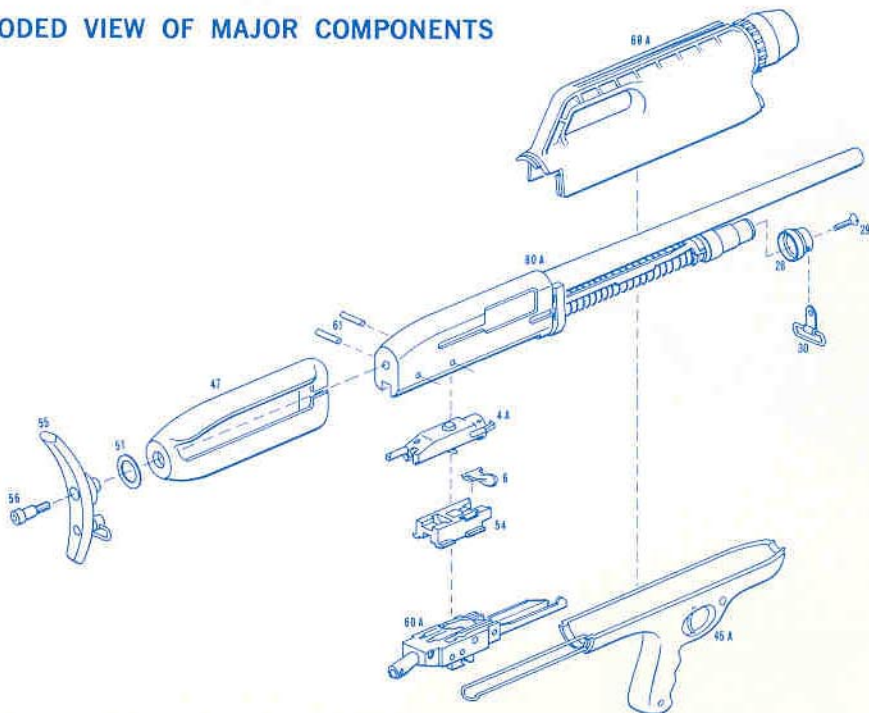

**CAUTION:** FOR SAFETY'S SAKE DO NOT ATTEMPT TO REPAIR SHOT GUN WITHOUT RECEIVING RELIABLE ADV

## PARTS LIST FOR MODEL TEN SERIES "A" 12 GAUGE AUTOLOADING POLICE SHOTGUN

All parts identified with this mark (\*\*) sold for factory installation only. Return complete shotgun to factory. Do not order repair parts by reference number, always use the part number.

(PRICES SUBJECT TO CHANGE WITHOUT NOTICE)

REF. NO.	PART NO.	DESCRIPTION	RETAIL PRICE EACH
1	2216	Action Bar	\$ 9.50
2	733	Action Spring	.85
**3	6813	Barrel & Cyl. Assy.	30.00
**4A	6817	Bolt Assembly	25.00
**4	6866	Bolt	14.00
5	656	Cartridge Stop Spring, R.H.	.25
6	2409	Cocking Handle	1.50
7	6868	Cartridge Lifter	5.00
8	677	Cartridge Lifter Actuator Assembly	.90
9	610	Cartridge Lifter Actuator Hinge Pin	not sold
10	675	Cartridge Lifter Actuator Spring	.25
11	897	Cartridge Lifter Spring	.25
12	689	Cartridge Lifter Spring Plunger	.25
13	612	Cartridge Stop, R.H.	2.50
14	2244	Cartridge Stop, L.H.	4.50
15	865	Cartridge Stop Pin Retaining Clip	.25
16	864	Cartridge Stop Pin	.25
17	777	Cartridge Stop Spring, L.H.	.25
18	739	Ejector	1.00
19	627	Firing Pin & Ejector Retaining Pin	.25
20	846	Ejector Retracting Spring	.25
21	6865	Extractor, R.H.	2.25
22	1022	Extractor Spring, R.H.	.30
23	119	Extractor Hinge Pin	.25
24	626	Firing Pin	1.00
25	628	Firing Pin Retracting Spring	.25
26	873	Escapement Hook	1.00
27	6805	Housing Coupling	6.00
28	6821	Forehand Cap	1.50
29	6653	Forehand Cap Screw	.25
30	2163	Front Swivel Assembly	1.20
31	6818	Hammer	2.50
32	699	Hammer Hinge Pin	.25
33	641	Hammer Strut, R.H.	.35
34	642	Hammer Strut, L.H.	.35
35	643	Hammer Strut Pin	.25
36	762	Hammer Spring	.25
37	639	Hammer Spring Guide	.25
38	676	Hammer Spring Retaining Pin	.25
39	691	Locking Pin	3.00
40	645	Magazine Follower	.50
41	2263	Magazine Spring	.50
42	2264	Magazine Tube	4.50

REF. NO.	PART NO.	DESCRIPTION	RETAIL PRICE EACH
43	648	Magazine Tube Cap	\$ .95
44	2230	Piston	3.00
45	6802	Pistol Grip Housing	13.00
46	6839	Pistol Grip Sling Pin	.50
47	6803	Receiver Housing	13.00
48	6808	Safety Button	1.00
49	6848	Safety Spring Plunger	.50
50	155-B	Safety Plunger Spring	.25
51	735	Shoulder Yoke Spring	.25
52	20732	Trigger Return Spring	.25
53	6844	Sear Set Screw	.70
54	6855	Slide	6.00
55	6804	Shoulder Yoke	3.50
56	6841	Shoulder Yoke Bolt	1.50
57	6825	Rear (Front) Swivel Assembly	1.25
58	6840	Rear Swivel Nut	.50
59	6807	Trigger	2.50
60A	6815	Guard Assembly	30.00
60	6816	Guard	10.00
61	6843	Guard Retaining Pins	.50
62	672	Guard Retaining Pin Bushing Front	.50
63	673	Guard Retaining Pin Bushing Rear	.50
64	674	Guard Retaining Pin Bushing Retaining Spring	.25
65	6809	Sear	4.00
66	874	Escapement Hook Spring	.25
67	6842	Trigger Retaining Pin	.50
68	6814	Trigger Rod	3.00
69	6801	Search-light Housing	17.00
70	6806	Search-light Switch	2.50
71	6838	Search-light Base Spring	.50
72	6837	Search-light Contact Bar	.50
73	6835	Shell and Spring Assembly	1.50
74	6836	Search-light Bulb	.50
75	6828	Reflector & Wire Guard Assembly	4.00
76	6830	Lens	.50
77	6829	Search-light Head	3.00
78A	6812	Receiver, Barrel & Cyl. Assy.	not sold
78	6810	Receiver	not sold
80	6819	Trigger Rod Lock Nut	.50
81	6820	Rod Washer	.50
82	6850	Base Spring Plug	.50
83	6851	Battery "O" Ring	.50
84	2826	Carrying Sling	.80

## DIS-ASSEMBLY FOR CLEANING

ILLUSTRATION #4

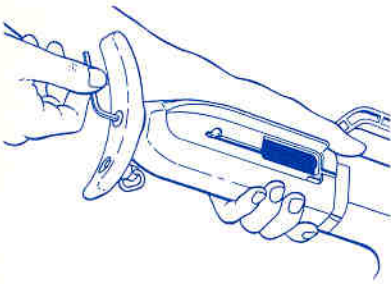

**STEP ONE — Removing Shoulder Yoke.** Open Action — Be sure gun is completely empty before starting disassembly. (See unloading information on page 2). Using a 3/16" hex key as shown in figure 4, remove shoulder yoke, bolt and washer.

ILLUSTRATION #5

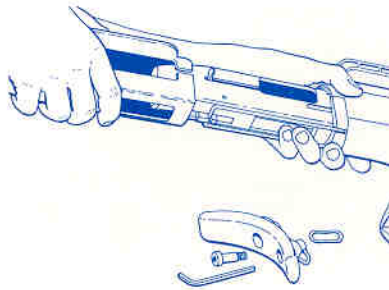

**STEP TWO — Removing Receiver Housing.** After removal of items in illustration #4, slide receiver housing rearward to remove.

ILLUSTRATION #6

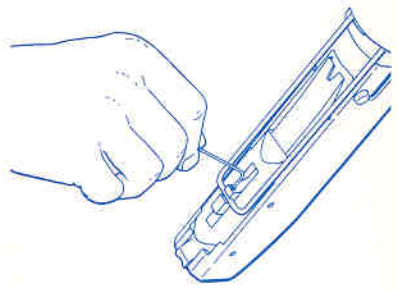

**STEP THREE — Removing Trigger Rod from Sear.** Using a 3/64" hex key loosen sear set screw until trigger rod can be freely lifted from slot.

**Note:** Assembly is done in reverse order. It is important that the sear set screw be brought up tight against the rod and backed-off approximately 1/4 turn.

ILLUSTRATION #7

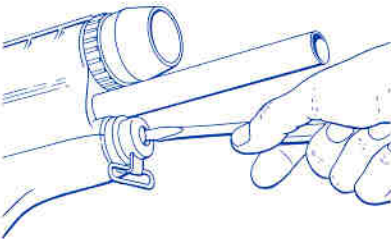

**STEP FOUR — Removing Front Magazine Cap.** Front magazine cap is disassembled by removing cap screw as shown. Front cap and sling swivel are then removed together.

ILLUSTRATION #8

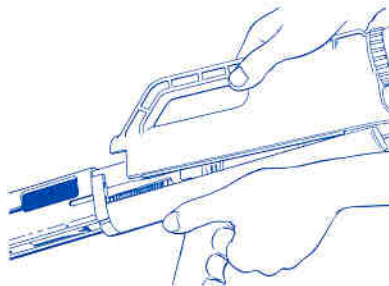

**STEP FIVE — Disassembly of Search-light Housing.** After removal of front magazine cap — search-light housing can be removed by sliding forward.

ILLUSTRATION #9

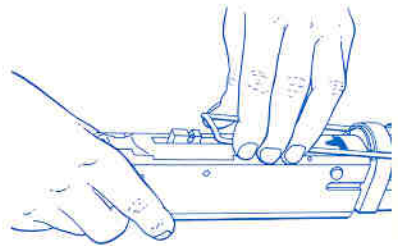

**STEP SIX — Removing Trigger Guard and Pistol Grip.** Close action by depressing cartridge stop button. Trigger rod and pistol grip housing can now be removed. Lift trigger rod clear of sear notch and slide forward approximately 2". Trigger rod can now be removed by springing the rod out of either slot in trigger guard housing coupling.

**Note:** Re-assemble in reverse order.

ILLUSTRATION #10

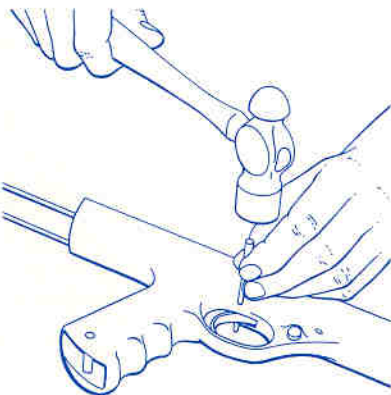

**STEP SEVEN — Removing Trigger Retaining Pin.** To remove trigger retaining pin, drive out with punch as shown in illustration #10.

**Note:** Drive pin from right to left. Re-assemble in reverse order.

ILLUSTRATION #11

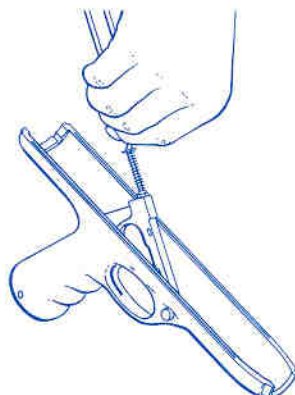

**STEP EIGHT — Dis-assembly of Pistol Grip Housing.** To remove trigger spring, rod and assembly, dis-engage safety by pushing from right to left, then grasp trigger and draw rearward and out.

**Note:** Assemble in reverse order.

### CLEANING THE ACTION

The Model Ten has been designed to practically eliminate lubrication of all operating parts. However, it is important to keep the following parts of the action clean and free from residue build-up. After removing the search-light housing and pistol grip unit, the operating piston, spring and magazine tube will be exposed. Do not remove magazine tube or piston from gun. Retract piston manually and clean tube and piston parts thoroughly with a solvent to remove all residue. Dry the action with an air hose or wipe clean with a lint-free cloth. **Do not oil these parts.**

# OTHER LAW ENFORCEMENT FIREARMS

from **HIGH STANDARD**

## DERRINGER — *The Ideal "Second Gun"*

1. **FLAT and THIN** for easy concealment. Light weight — 11 oz. — for law enforcement hide-out gun.
2. **BUILT IN SAFETY** hammer block. Won't fire if dropped.
3. **DOUBLE ACTION** — smoothest, safest, fastest handling Derringer made.
4. **TWO SHOTS.** (Single shot Derringers give only one chance at your target).
5. **PALM FILLING GRIP** designed for shooting control.
  - (a) Model 9193 shoots .22 Long Rifle (use of hollow-point cartridges recommended.)
  - (b) Model 9194 shoots .22 Rim Fire Magnum caliber, high velocity, hollow-points and full metal case bullets — A Tremendous Wallop!
6. **HAMMERLESS** — no snag on pocket. (Hammer types are almost impossible to cock for second shot).
7. **RECESSED HEAD SPACE** for extra safety.
8. **DUAL EXTRACTION.** Easy to load and operate.
9. **ALL STEEL** unit is encased in rich blue, anodized, light weight alloy housing.
10. **DURABLE** and accurate barrels — all steel.

**.22 Caliber L.R.**  
**Stock #9193**



**.22 Caliber Magnum**  
**Stock #9194**

## RIOT GUNS — *Accurate, Hard Hitting*

designed exclusively for police use by High Standard



**MODEL 8111**  
18" Barrel — 7 Shots



**MODEL 8113**  
18" Barrel — 7 Shots — Rifle Sights



**MODEL 8104**  
20" Barrel — 6 Shots

MODEL NUMBER	GAUGE	MAGAZINE CAPACITY	SIGHT	BARREL LENGTH	OVERALL LENGTH	WEIGHT LBS.	SHIPPING WEIGHT LBS.
8111	12	7*	Beaded Ramp	18"	37 <sup>3</sup> / <sub>4</sub> "	7 <sup>1</sup> / <sub>8</sub>	8
8113	12	7*	Adj. Rifle	18"	37 <sup>3</sup> / <sub>4</sub> "	7 <sup>1</sup> / <sub>8</sub>	8
8104	12	6**	Beaded Ramp	20"	39 <sup>3</sup> / <sub>4</sub> "	7	8 <sup>1</sup> / <sub>2</sub>

### SPECIAL FEATURE

All Riot Gun stocks and forearms are oiled American walnut. Stocks are drilled for quick attachment of sling swivels. Sling and swivels are available as extra option.

\*7 shots with six shells in magazine and 1 in the chamber.

\*\*6 shots with five shells in magazine and 1 in the chamber.

**HIGH STANDARD**  
SPORTING FIREARMS