

# Centurion In-Line Muzzle-Loading Rifle

Instruction and Safety Manual

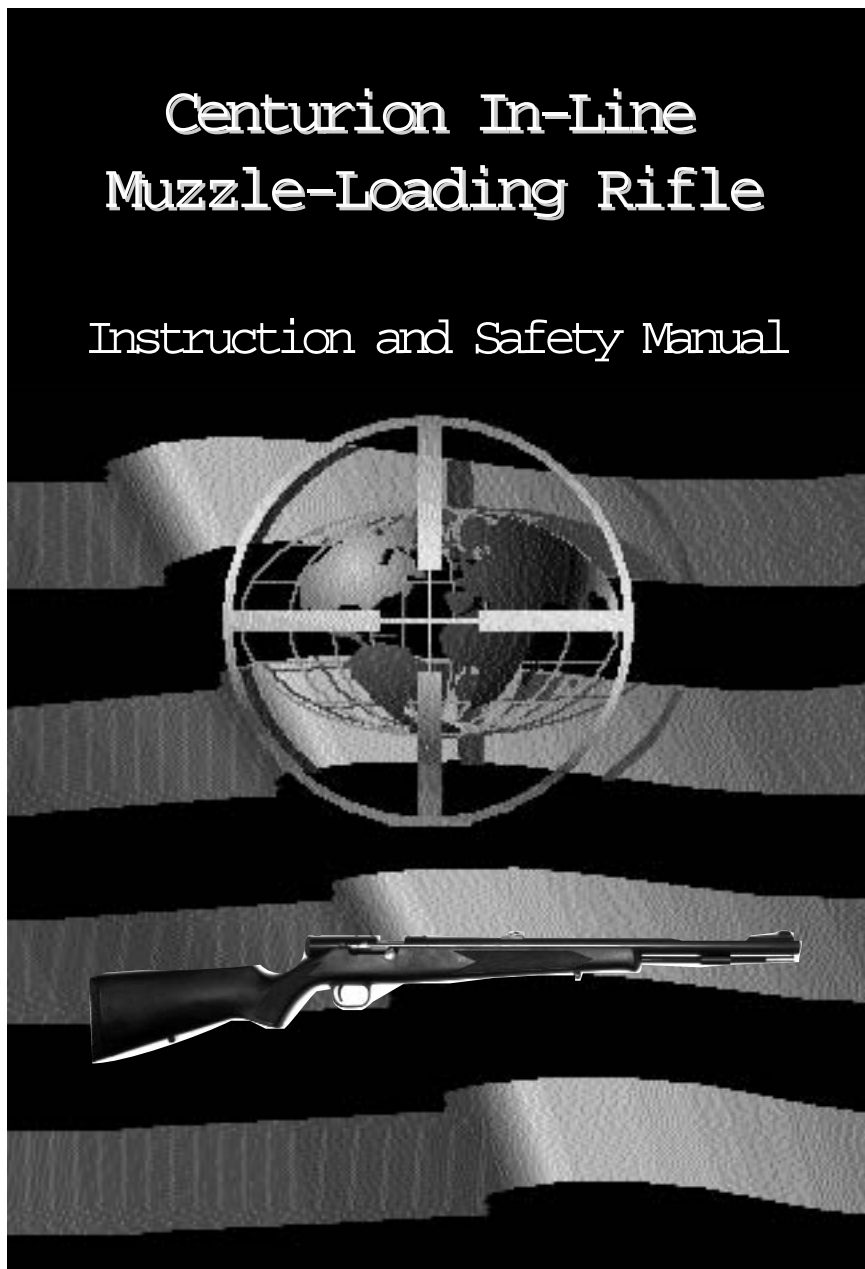

**CENTURY  
INTERNATIONAL  
ARMS**

Black powder shooting is more than a single-shot challenge with a rifle that has to be "hand-loaded" from the front. Muzzleloading is basic, but not simple. It's a fascinating, multi-faceted sport that demands concentration and attention to details.

Shooting Industry Magazine, May 1997

---

At Century International Arms, North America's largest importer/exporter of surplus firearms and accessories, we have catered to the collector, the hunter and shooter for over 30 years.

Whether you're in the business or just shopping for yourself, we'll work even harder to meet your needs. We have decades of experience dealing directly with sporting goods retailers and wholesalers worldwide through an established network of distribution centers in Vermont and Florida. In addition to surplus goods, we also carry newly manufactured firearms, knives, swords, ammunition scopes and related accessories.

We've earned a solid reputation for offering converted firearms with proven performance qualities at an affordable price. See for yourself why hunters, shooters collectors around the world opt for Century.



**CENTURY  
INTERNATIONAL  
ARMS INC.**

## CONTENTS

1.	Introduction.....	Page 3
2.	Safety First.....	Page 3
3.	Specifications.....	Page 4
4.	Loading Your Muzzle Loader.....	Page 5
5.	Cocking and Capping.....	Page 6
6.	To Fire.....	Page 7
7.	Failure to Fire.....	Page 7
8.	Recommended Loads.....	Page 8
9.	Sights.....	Page 8
10.	Safety.....	Page 9
11.	Disassembly.....	Page 9
12.	Cleaning Your Rifle.....	Page 9
13.	Exploded Diagram.....	Page 10
14.	Liability.....	Page 11

## INTRODUCTION:

Muzzle Loading is the fastest growing shooting sport. Many states have adopted special black powder hunting seasons which give the hunter extended hunting seasons. There are also black powder target shoots springing up all over the country. This influx in the use of black powder weapons has led to many innovations; the in-line system being the most prevalent. We sincerely hope you enjoy your Centurion In-Line Rifle, but as with any firearm, care must be taken to ensure proper use.

Please read and understand this Owner's Manual completely before you venture out to the field, or range. Good Shooting!

### NOTE:

If you are new to the sport of Muzzle Loading, we suggest you enroll in a safety course conducted by a qualified instructor, the N.R.A., or The National Muzzle Loading Rifle Association.

## SAFETY FIRST:

Firearms can be dangerous and can cause serious injury or death. Proper and safe firearms handling is the responsibility of anyone who touches or uses a firearm. Safety has to be the primary consideration of anyone using a firearm.

When purchasing a firearm, you assume responsibility for its safe use, storage and transportation. Particularly, it is critical that firearms be kept from unauthorized use, and this includes children. Your responsibility also includes, but is not limited to, the need to protect yourself and others from injury resulting from the misuse or abuse of a firearm.

- At all times, treat firearms as though they are loaded.
- Always be aware of where the muzzle is pointed.
- At all times, carry your firearm in a way that will preclude accidental injury to yourself or others in the event you should stumble, fall, or drop the firearm.
- Before shooting, make certain the barrel has no obstructions.
- Do not allow a firearm or ammunition to be left unattended. Secure both the firearm and ammunition from access by unauthorized people, including children.

- When shooting, always be certain that the area beyond the target, including the backstop, is clear and safe. Also make certain that shots fired present no safety hazards for yourself, or others.
- Always use both ear and eye protection when shooting.
- Always use loads designed for and intended to be used in the firearm you are shooting (see Load Chart on page 8). It must be the proper caliber and type for your firearm.
- Always understand the proper operation of your firearm, and never allow the firearm to be used by anyone who does not understand how to use the firearm properly and safely.
- Never pass a firearm to another person unless the action is open and the firearm is in an unloaded and safe condition. Never put your finger into the trigger guard until you are ready to shoot.
- When not using the firearm, insure that it is unloaded.
- Store your firearm unloaded in an area which is secure from unauthorized access. Further, store your powder separately, and in an area secure from unauthorized access.

## **SPECIFICATIONS:**



Caliber: .50 Caliber  
BBL Length: 24"  
Overall Length: 42"  
Rate of Twist: 1-32  
Weight: 8 lbs. 1 oz.

## LOADING YOUR MUZZLE LOADER:

### WARNING:

Refer to the Recommended Load Chart (page 8) for suggested loads for the type of bullet you are using. Do Not Exceed Maximum Loads!!

### Use only:

2F/FFG Black Powder  
Pyrodex (TM) RS  
Pyrodex (TM) Select

in the Centurion In-Line Muzzle Loader. Do Not Use Smokeless Powders!!

1. Wear your safety glasses. Do not load while smoking.
2. Place cocking handle in the safe position. Do not install the percussion cap.
3. Ensure the bore and nipple are clean and dry.
4. Pour the measured powder charge down the clean dry bore.

### PATCHED ROUND BALLS:

1. Lubricate a dry cloth patch and place it in the center of the muzzle.
2. Place the lead ball on top of the patch (flat side up, if applicable).
3. Using a ball starter, push the ball into the bore until it is flush with the muzzle.
4. Cut away any remaining patch material with a knife.
5. Using the longer rod on the ball starter, push the ball deeper into the bore.
6. Grasp the ramrod 8" from the bottom. Push the ball to this point.
7. Apply firm pressure and push the ball until it seats on top of the powercharge.

**NOTE:**

A space between the powder charge and ball may cause excessive pressure resulting in injury to the rifle, the shooter or bystanders. NEVER use a sabot or plastic patch with a round ball.

**CONICAL BULLETS:**

1. Lubricate the Conical Bullet with a commercial lubricant.
2. Start the bullet into the bore with the bullet starter.
3. Using the long rod of the bullet starter, push the bullet as far as it will go.
4. Repeat Step 5 and 6 as above.

**NOTE:**

Always use the correct size bullet for your rifle. The bullet should fit snugly and require moderate pressure to seat the bullet on top of the powder. Leave no gap between the bullet and the powder. Do not use cloth patches on Conical Bullets.

**SABOTED PISTOL BULLETS:**

1. Place the bullet into the sabot. Push firmly until the base of the bullet seats to the bottom of the sabot.
2. Place the bullet sabot into the muzzle of the rifle.
3. Push the bullet sabot down the bore using moderate pressure until it sits on top of the powder charge.

**NOTE:**

Once you have loaded your rifle, it is a good idea to insert the ramrod into the bore until it rests on the projectile. Mark the rod at the point where it meets the muzzle with tape. This mark will give you an easy reference as to whether or not your rifle is loaded or if you have double charged your rifle. Always insure that you remove the ramrod before firing.

**COCKING AND CAPPING:**

With the rifle pointed in a safe direction, pull the cocking handle rearward and up into the safety notch. Press a No. 11 percussion cap tightly onto the nipple.

**TO FIRE:** (Keep fingers off the trigger)

Pull back slightly on the cocking handle and ease it downward out of the safety notch. Ease the cocking handle forward until it stops (approximately ½ inch). The rifle is now ready to fire. Place the rifle snugly to your shoulder, take aim and squeeze the trigger.

**FAILURE TO FIRE:**

1. Should your rifle fail to fire, keep the muzzle pointed in a safe direction for at least one full minute.
2. Place the cocking handle in the safety notch.
3. With the muzzle pointed up and away from you or bystanders, tap the butt against the ground. This will force powder into the ignition channel of the breech plug.
4. Replace the spent percussion cap with a new one and fire again.
5. If the rifle fails to fire again, wait another minute with the gun in a safe direction, remove the cap and nipple, insert a small amount of powder into the nipple hole. Replace the nipple and tighten. Recap the nipple with a fresh percussion cap and fire.
6. If the rifle fails to fire once again:
  - 1) Keep the muzzle pointed in a safe direction for one minute minimum.
  - 2) Remove the bolt spring cap, bolt spring, follower, cocking handle.
  - 3) Submerge the barreled receiver completely in water for ½ hour.
  - 4) Remove from the water and shake out the wet powder.
  - 5) Remove the projectile from the bore with the ramrod.
  - 6) Clean the barrels thoroughly.
  - 7) Reassemble gun complete.



## RECOMMENDED LOADS:

The modern Black Powder shooter has more load options than ever before. We strongly recommend that the user look over and select the type of projectile most suited for his application and match it with a power charge of either 2F/FFG Black Powder or Pyrodex<sup>(TM)</sup> starting low and working up but not exceeding the maximum charge.

The 1:32 rifling twist of the Centurion In-Line Muzzle Loading Rifle allows the user his choice of Round Balls, Conical Bullets, or Saboted Bullets with good results.

### RECOMMENDED LOADS

#### Patched Round Balls:

Rifle Caliber	Ball Diameter	Patch Thickness	Black Powder Charge*			
			Most Accurate		Maximum	
			Grains	Granulation	Grains	Granulation
.50	.490"	.015"	50-75	2 f	110	2f
.54	.530"	.015"	55-80	2 f	125	2f

#### Conical Bullets:

Rifle Caliber	Ball Caliber	Bullet Weight	Black Powder Charge*			
			Most Accurate		Maximum	
			Grains	Granulation	Grains	Granulation
.50	.50	385gr.	70-90	2 f	100	2f
.54	.54	425gr.	80-100	2 f	110	2f

#### Saboted Pistol Bullets:

Rifle Caliber	Ball Caliber	Bullet Weight	Black Powder Charge*			
			Most Accurate		Maximum	
			Grains	Granulation	Grains	Granulation
.50	.50	385gr.	70-90	2 f	100	2f
.54	.54	425gr.	80-100	2 f	110	2f

\* Commercial grade black powders designed for muzzle loaders should be used. The only other propellant which may be used is Pyrodex<sup>(TM)</sup> RS (Rifle and Shotgun Powder). Pyrodex<sup>(TM)</sup> produces approximately the same results as an equivalent volume (not weight) of black powder. Therefore, the recommended changes apply in Pyrodex<sup>(TM)</sup> if a powder measure graduated in grains (as most powder measures are) is used. If you weight your Pyrodex<sup>(TM)</sup> charge, the recommended charge should be reduced by 20%.

## SIGHTS:

Your Centurion In-Line Rifle is equipped with iron sights. The rear sight is adjustable for windage and elevation. To move your shot group

down, move the rear sight down. To move your group to the left, move the sight left. The receiver is drilled and tapped to accept Mauser 98 scope bases available through your local gun dealer.

## **SAFETY:**

To place your rifle in a safe position, draw back and up on the cocking handle until the handle is completely in the top of the safety notch. No safety is foolproof. Always keep the muzzle pointed in a safe position.

## **DISASSEMBLE:**

Insure that your rifle is unloaded and there is no cap on the nipple before you proceed.

1. Remove the ramrod.
2. Remove the stock by unscrewing the forward trigger guard screw and the front sling swivel.
3. With the bolt in the forward position, unscrew the bolt spring cap. Note this cap is under spring tension, USE CAUTION!
4. Remove spring and follower.
5. With the trigger pulled back, move the bolt fully rearward and remove the cocking handle. Slide the bolt from the receiver.
6. Remove the trigger assembly by unscrewing the two Allen head screws.
7. Using the tool provided (in the butt of the rifle) remove the nipple and breech plug.

Reassemble by reverse order.

## **CLEANING YOUR RIFLE:**

Black Powder residue is highly corrosive. The rifle should be cleaned and lubricated after each use.

Strip the rifle as in the disassembly section.

Scrub the bore using warm soapy water and a brush of proper size. Air dry. Clean the bolt, cocking handle, breech plug and nipple using warm soapy water or a commercial cleaner and brush. Air dry. Lubricate using Break Free or another commercial protecting oil.

**NOTE:**

Insure that the nipple and bore are oil free before loading.

## Exploded Diagram

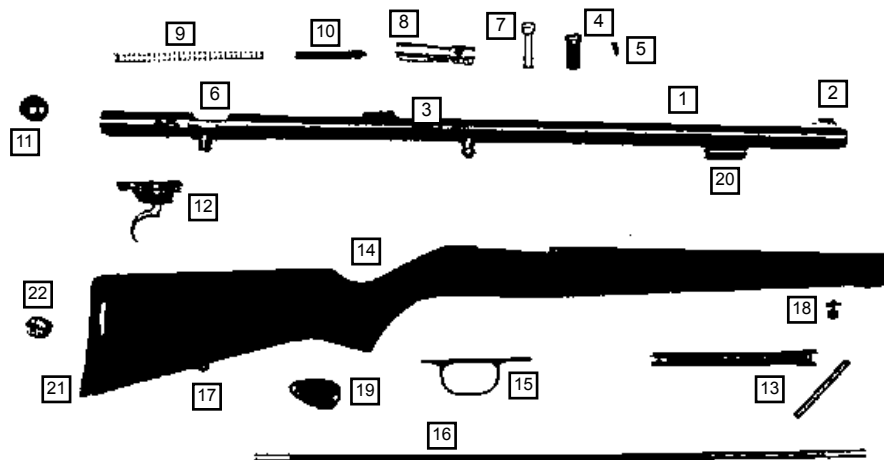

**PARTS KEY**

- |                         |                                 |
|-------------------------|---------------------------------|
| 1. Barrel               | 12. Trigger Group               |
| 2. Front Sight Assembly | 13. Take Down Tool              |
| 3. Rear Sight Assembly  | 14. Stock                       |
| 4. Breech Plug          | 15. Trigger Guard               |
| 5. Nipple               | 16. Ram Rod                     |
| 6. Action Body          | 17. Rear Sling Swivel Stud      |
| 7. Bolt Handle          | 18. Front Sling Swivel Stud     |
| 8. Bolt                 | 19. Pistol Grip Patch Box Cover |
| 9. Bolt Spring          | 20. Ram Rod Ferrel              |
| 10. Bolt Follower       | 21. Butt Plate                  |
| 11. Receiver Cap        | 22. Butt Stock Storage Cap      |

## LIABILITY:

Muzzle Loading weapons are classified as firearms and could cause harm or death if not used in a proper manner. They are sold by us with the specific understanding that we are not legally responsible in any manner for their improper use, negligent handling or improper resale under local laws and or regulations. Century International Arms, Inc., and its successors and assigns shall not be held liable for the malfunctioning of the firearm or for physical injury or property damage resulting in whole or in part from including, but not limited to (a) criminal or negligent discharge (b) improper or careless handling (c) unauthorized modifications (d) defective, improper, hand loaded or reloaded ammunition (e) corrosion (f) neglect (g) other influences beyond our immediate or direct control. This limitation applies regardless of whether liability is asserted on the basis of contract, negligence or strict liability (including any failure to warn). Under no circumstances shall Century International Arms, Inc., be liable for incidental or consequential damages, such as loss of use of property, commercial loss or loss of earnings or profits.

CENTURY INTERNATIONAL ARMS, INC.  
1161 Holland Drive  
Boca Raton, Florida 33487 U.S.A.  
Toll Free: 1-800-527-1252  
Tel: (561) 998-1997  
Fax: (561) 998-1993  
E-Mail: Support@CenturyArms.com

